

INMIG-400/500 DP is microprocessor controlled digital synergic double pulse MIG machine. It has multifunction capability and is loaded with programs for different materials.

Features

- ✓ Inverter based with latest Soft switching Technology
- ✓ Micro controller based for precise control
- ✓ Highly energy efficient and high power factor
- ✓ Normal /Synergic Mode
- ✓ Can work in single /Double Pulse mode
- ✓ 2 / 4 Step Mode
- ✓ Special 4 Step mode for delivery high curing during start
- ✓ Arc Length adjustment function
- ✓ Adjustable Arc force
- ✓ Adjustable crater voltage and crater current.
- ✓ Adjustable Pre / Post gas flow time
- ✓ Adjustable Burn Back Time
- ✓ Spot Welding function
- ✓ Suitable for different kind of base metals
- ✓ Memory channels to store data

Material Selection:

- Fe (CS)
- AlSi (Aluminum)
- AlMg (Aluminum)
- CrNi (Stainless Steel)
- Cu (Copper)

Process:

- SMAW
- GMAW
- GMAW-Synergic
- GMAW-Pulse
- GMAW- Double Pulse

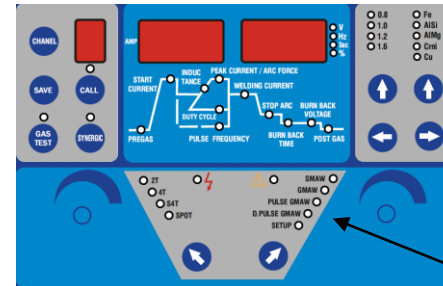

Basic Outfits

- Power Source
- Closed Wire Feeder
- 5 Meters Long Inter connecting cable
- Earth cable with Clamp
- 3 Meters Long MIG Welding Torch
- Regulator flowmeter & Gas pre Heater

Optional Accessories

Water cooling system with Water cooled Torch

Technical Specifications

Model	INMIG-400 DP	INMIG-500 DP
Input Supply	380 ~ 440 Volts 3 Phase 50 Hz Supply	
Input KVA	18.4	25
Welding Current Range	20 ~ 400	20 ~ 500
Voltage Setting Range (V)	15 ~ 40	15 ~ 40
Pre Gas Time (Sec)	0 ~ 3	
Post Gas Time (Sec)	0 ~ 20	
Peak Current Range (Amps)	20 ~ 400	20 ~ 500
Pulse Frequency (Hz)	0.1 ~ 9.9	
Duty Cycle (%)	10 ~ 90	
Burn Back Time (Sec)	0.01 ~ 0.5	
Burn Back Voltage (V)	5 ~ 20	
Crater Voltage Setting (V)	-5 ~ 5 from the set voltage	
Crater Current (Amps)	0 ~ 400	0 ~ 500
Welding Mode	2/4/S4 Step	
Wire Selection	0.8 /1.0 /1.2/1.6	
Power Factor	0.95	
Efficiency	89	
Duty Cycle	60% at Full Load	
Weight of Power Source	42 Kg	46 Kg